



# 200 Series Regulators

# 206 SERIES

The 206 Series regulators are intended for primary pressure control of gases supplied from cryogenic liquid cylinders.

- Single Stage
- Chrome-Plated Forged Brass Body
- 316L Stainless Steel Diaphragm
- Liquid Cylinder Regulator
- Four Port Configuration

## Typical Applications

- Argon
- Nitrogen
- Oxygen
- Carbon dioxide



206 3021-580 shown

## Features

- CAPSULE® Seat**  
Increased serviceability and life
- 316L Stainless Steel Diaphragm**  
No inboard diffusion
- Forged Body**  
Durable, long-lasting construction
- Field-Adjustable Pressure Limit**  
Safeguard downstream equipment
- Large Convoluted Diaphragm**  
Smooth pressure changes
- Standard Relief Valve**  
Diaphragm and gauge protection
- Designed for Low Inlet Pressures**  
Optimized flow with liquid cylinders
- Large CAPSULE® Seat**  
Permits flow rates unobtainable with conventional regulators
- 3000 PSIG (210 BAR) Inlet Pressure Rating**  
Safe use on high pressure cylinders

## Materials

- Body**  
Chrome-plated forged brass
- Bonnet**  
Chrome-plated die-cast zinc
- Seat**  
PTFE
- Filter**  
10 micron sintered bronze
- Diaphragm**  
316L stainless steel
- Internal Seals**  
PTFE

## Specifications

- Maximum Inlet Pressure**  
3000 PSIG (210 BAR)
- Temperature Range**  
-40°F to 140°F (-40°C to 60°C)
- Gauge**  
2 1/2" (68mm) diameter chrome-plated brass
- Ports**  
1/4" FPT
- Helium Leak Integrity**  
1 x 10<sup>-8</sup> scc/sec
- Cv**  
0.28  
*See page 206 for flow curves*
- Weight (206 3021-580)**  
3.5 lbs. (1.59 kg)

CRN 0H5216.5R1

# 200 Series Regulators



## Installation Dimensions

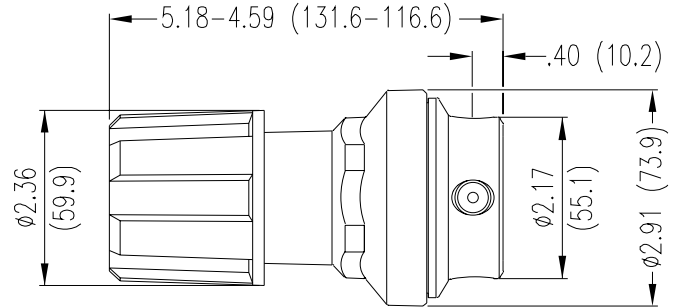
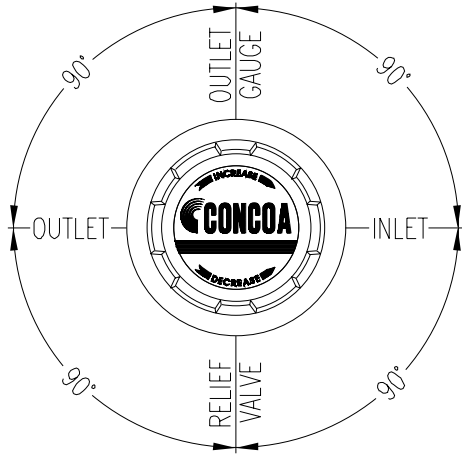

## Ordering Information

| 206        | A                               | B                       | C              | D   | -CON  | Options   |   |
|------------|---------------------------------|-------------------------|----------------|---|---|---|---|
| Series 206 | Outlet Pressure                 | Outlet Gauge            | Inlet Gauge    | Outlet Assemblies                           | Assembly Gauges                               | Inlet Connections                                   | Installed Options   |
|            | <b>1:</b> 0-15 PSIG (0-1 BAR)   | 0-30 PSIG/<br>0-2 BAR   | <b>0:</b> None | <b>0:</b> 1/4" FPT port                     | <b>0:</b> Bare body                           | <b>000:</b> 1/4" FPT                                | <b>B:</b> Protocol alarm station with pressure switch gauges  |
|            | <b>2:</b> 0-40 PSIG (0-3 BAR)   | 0-60 PSIG/<br>0-4 BAR   |                | <b>1:</b> 1/4" MPT                          | <b>1:</b> Standard assembly (PSIG/kPa gauges) | <b>TF2:</b> 1/8" tube                               | <b>C:</b> Protocol switchover station   |
|            | <b>3:</b> 0-120 PSIG (0-8 BAR)  | 0-200 PSIG/<br>0-14 BAR |                | <b>2:</b> 1/4" tube fitting                 | <b>2:</b> Standard assembly (BAR/PSIG gauges) | <b>TF4:</b> 1/4" tube                               | <b>E:</b> Protocol alarm station with intrinsically safe transducer for hazardous environments            |
|            | <b>4:</b> 0-200 PSIG (0-14 BAR) | 0-400 PSIG/<br>0-27 BAR |                | <b>3:</b> Diaphragm valve 1/4" tube fitting |   | <b>TF6:</b> 3/8" tube                               | <b>H:</b> Protocol switchover alarm station with pressure switch gauges                                   |
|            |                                 |                         |                | <b>4:</b> Diaphragm valve 1/4" MPT          |   | <b>M06:</b> 6mm tube                                | <b>J:</b> Protocol alarm station with standard transducer for non hazardous environments                  |
|            |                                 |                         |                | <b>5:</b> Needle valve 1/4" MPT             |   | CGA<br>DIN 477<br>BS 341<br>and others<br>available | <b>K:</b> Protocol switchover alarm station with standard transducer for non hazardous environments       |
|            |                                 |                         |                | <b>6:</b> 1/8" tube fitting                 |   |   | <b>M:</b> Protocol station  |
|            |                                 |                         |                | <b>7:</b> 3/8" tube fitting                 |   |   | <b>Q:</b> Protocol purge station  |
|            |                                 |                         |                | <b>8:</b> Diaphragm valve 1/8" tube fitting |   |   | <b>X:</b> Protocol switchover alarm station with intrinsically safe transducer for hazardous environments |
|            |                                 |                         |                | <b>9:</b> Diaphragm valve 1/4" FPT          |   |   |   |
|            |                                 |                         |                | <b>A:</b> 3/8" BSP RH fitting               |   |   |   |
|            |                                 |                         |                | <b>B:</b> Diaphragm valve 3/8" tube fitting |   |   |   |
|            |                                 |                         |                | <b>C:</b> 3/8" BSP LH fitting               |   |   |   |
|            |                                 |                         |                | <b>D:</b> 6mm brass hose barb               |   |   |   |
|            |                                 |                         |                | <b>G:</b> 1/8" stainless steel tube fitting |   |   |   |
|            |                                 |                         |                | <b>H:</b> 1/4" stainless steel tube fitting |   |   |   |
|            |                                 |                         |                | <b>M:</b> 6mm tube fitting                  |   |   |   |
|            |                                 |                         |                | <b>S:</b> Diaphragm valve 6mm tube fitting  |   |   |   |

REGULATORS