



300 Series Regulators

332 SERIES

The 332 Series regulators are intended for primary pressure control of ultra-high purity or corrosive gases for applications requiring constant pressure control and delivery regardless of supply pressure variations.

- Dual Stage
- 316L Stainless Steel Barstock Body
- Four Port Configuration
- 316L Stainless Steel Diaphragm

Typical Applications

- EPA Protocol gases
- Gas and liquid chromatography
- High purity carrier and gases
- Zero, span, and calibration gases
- High purity chamber pressurization

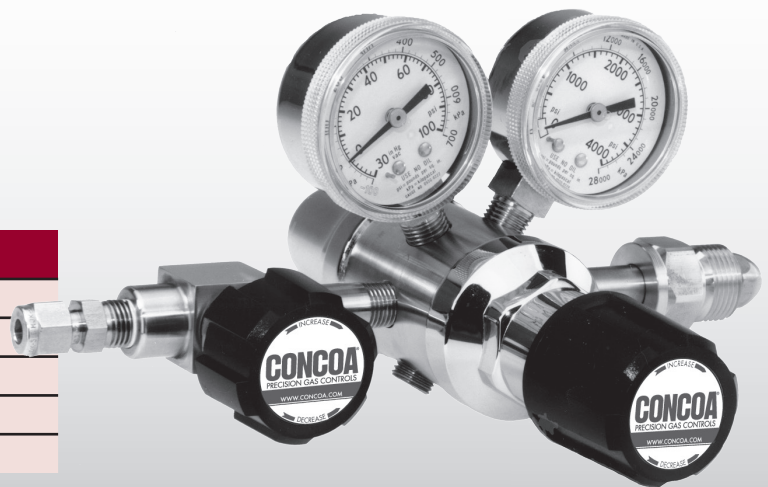

332 2331-580 shown

Features

- CAPSULE® Seat**
Increased serviceability and life
- 316L Stainless Steel Diaphragm**
No inboard diffusion
- Low Wetted Surface Area**
Minimal purge requirements
- Field-Adjustable Pressure Limit**
Safeguard downstream equipment
- Convolute Diaphragm**
Smooth pressure changes
- Compact Design**
Easily transported and integrated into systems
- 316L Stainless Steel Barstock Body**
Increased corrosion resistance
- 10 Micron Filtration in Both Stages**
Fail-safe seat performance
- Pressure Ranges 0-15 to 0-250 PSIG (0-1 to 0-17 BAR)**
Broad range of applications

Materials

- Body**
316L stainless steel barstock
- Bonnet**
Chrome-plated die-cast zinc
- Seat**
PCTFE (first stage)
PTFE (second stage)
- Filter**
Patented 10 micron 316 mesh
- Diaphragm**
316L stainless steel
- Internal Seals**
PTFE

Specifications

- Maximum Inlet Pressure**
3000 PSIG (210 BAR)
4500 PSIG (310 BAR) optional
- Temperature Range**
-40°F to 140°F (-40°C to 60°C)
- Gauges**
2" (53mm) diameter
Chrome-plated case
Stainless steel internals
- Ports**
1/4" FPT
- Helium Leak Integrity**
1 x 10⁻⁸ scc/sec
- Cv**
0.1
See page 202 for flow curves
- Weight (332 2331-580)**
4.2 lbs. (1.91 kg)

300 Series Regulators



Installation Dimensions

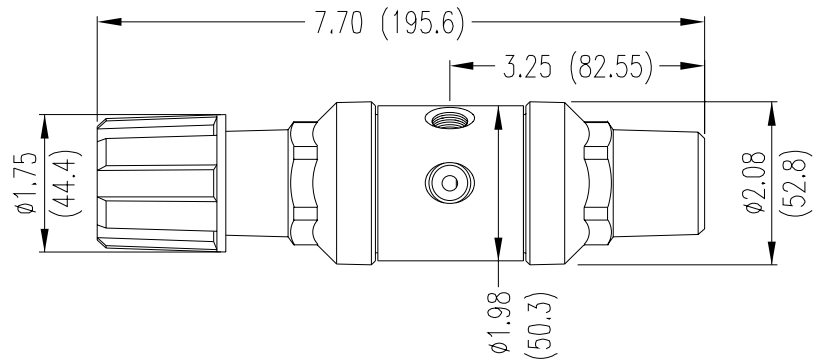
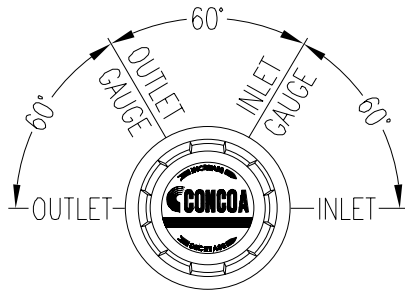

REGULATORS

Ordering Information

| 332 | A | B | C | D | -CON | Options | |
|------------|---------------------------------|--------------------------------|---|---|---|---|--|
| Series 332 | Outlet Pressure | Outlet Gauge | Inlet Gauge | Outlet Assemblies | Assembly Gauges | Inlet Connections | Installed Options |
| | 1: 0-15 PSIG (0-1 BAR) | 30"-0-30 PSIG/ -1-0-2 BAR | 0: None | 0: 1/4" FPT port | 0: Bare body | 000: 1/4" FPT | B: Protocol alarm station (110/220 VAC) |
| | 2: 0-50 PSIG (0-3.5 BAR) | 30"-0-100 PSIG/ -1-0-7 BAR | 3: 0-4000 PSIG/ 0-278 BAR | 1: 1/4" MPT | 1: Standard assembly (PSIG/kPa gauges) | TF2: 1/8" tube | C: Protocol switchover station |
| | 3: 0-100 PSIG (0-7 BAR) | 30"-0-200 PSIG/ -1-0-14 BAR | 5: 0-1000 PSIG/ 0-70 BAR | 2: 1/4" tube fitting | 2: Standard assembly (BAR/PSIG gauges) | TF4: 1/4" tube | H: Protocol switchover station with alarm (110/220 VAC) |
| | 4: 0-250 PSIG (0-17 BAR) | 0-400 PSIG/ 0-27 BAR | 6: 0-300 PSIG/ 0-21 BAR | 3: Diaphragm valve 1/4" tube fitting | | TF6: 3/8" tube | M: Protocol station |
| | 7: 0-150 PSIG (0-10 BAR) | 30"-0-200 PSIG/ -1-0-14 BAR | 7: 0-400 PSIG/ 0-27 BAR | 4: Diaphragm valve 1/4" MPT | | M06: 6mm tube | Q: Protocol purge station* |
| | | | 8: 0-6000 PSIG/ 0-415 BAR* | 5: Needle valve 1/4" MPT | | CGA DIN 477 BS 341 and others available | T: Tee purge* |
| | | | G: 0-4000 PSIG/ 0-275 BAR† | 6: 1/8" tube fitting | | | *Not available with 4500 PSIG (310 BAR) max inlet pressure |
| | | | <i>*Maximum inlet pressure 4500 PSIG (310 BAR) with PCTFE Seat CAPSULE®</i> | 7: 3/8" tube fitting | | | |
| | | | <i>†Maximum inlet pressure 3500 PSIG (240 BAR) with PCTFE seat CAPSULE</i> | 8: Diaphragm valve 1/8" tube fitting | | | |
| | | | | 9: Diaphragm valve 1/4" FPT | | | |
| | | | | M: 6mm tube fitting | | | |
| | | | | S: Diaphragm valve 6mm tube fitting | | | |