



605 Series Manifold Regulator

The 605 Series Regulators are intended for pressure control at the source of either liquid or high pressure cylinders for applications with pressure requirements up to 250 PSIG.

Advanced Features

- *Up to 3,000 PSIG Inlet Available*
Liquid or high pressure use
- *High Flow Delivery Regulator*
ISOFLOW™ seat design
- *40-Micron Internal Filter*
Limits possibility of gas contamination
- *Balance Stem Seat*
Eliminates decaying inlet pressure fluctuation
- *Stainless Steel Diaphragm*
UHP design



605-3311-580 shown

Applications

Liquid or High Pressure

Cylinder Use

Beam Purge
N₂ or O₂ assist

Bulk Gas Distribution Systems

Laser Welding Shielding Gases

CO₂, Argon, Helium

Materials

Body

Brass barstock

Bonnet

Chrome-plated die cast zinc

Seat

PTFE

Filter

40-micron 316L stainless steel mesh

Diaphragm

316L stainless steel

Internal Seals

PTFE

Specifications

Maximum Inlet Pressure

3,000 PSIG (210 BAR)

Temperature Range

-40°F to 140°F (-40°C to 60°C)

Gauges

2" diameter brass

Ports

½" FPT (inlet/outlet)
¼" FPT (gauges)

Helium Leak Integrity

1 x 10⁻⁸ scc/sec

Cv

1.0

Weight

4.4 lbs. (2 kg)

Flow Performance Curves

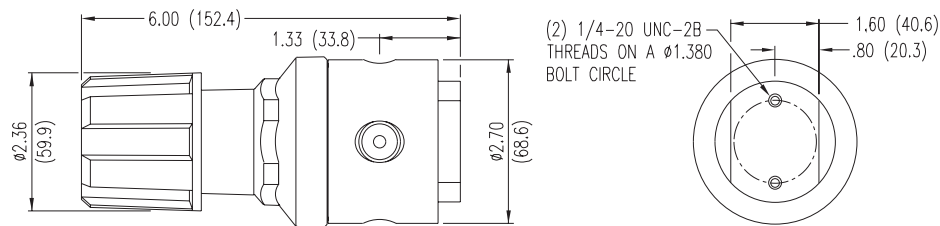
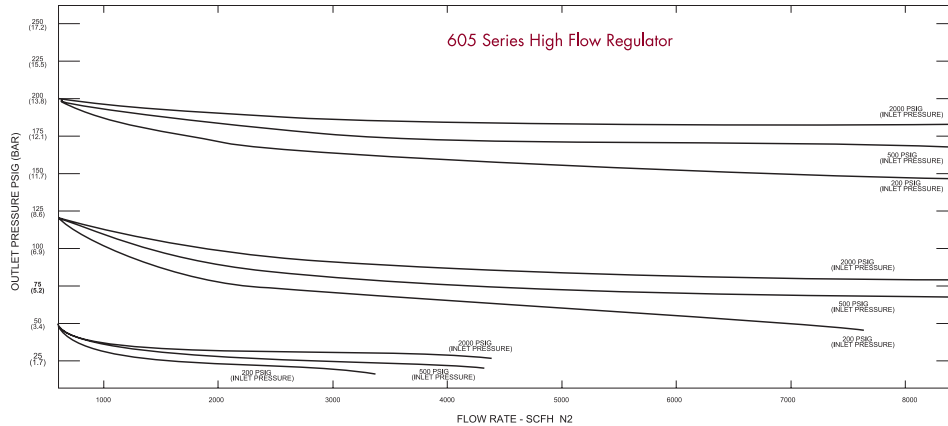

Ordering Information

| 605 | A | B | C | D | Inlet | Options | |
|------------|-----------------|--------------|--------------|---------------------|--------------------------------------|--------------------------------|--|
| Series 605 | Outlet Pressure | Outlet Gauge | Inlet Gauge | Outlet Assemblies | Assembly/ Gauges | Connections | Installed Options |
| | 1:0-15 PSIG | 0-30 PSI | 3:0-4000 PSI | 0:½" FPT Port | 1:Standard Assembly (PSI/kPa Gauges) | 000:½" FPT | A:Laser Gas Alarm Station (110V) |
| | 2:0-40 PSIG | 0-60 PSI | 9:0-600 PSI | 1:½" Tube Fitting | 2:Standard Assembly (BAR/PSI Gauges) | M12:12mm Tube Fitting | B:Laser Gas Alarm Station (220V) |
| | 3:0-120 PSIG | 0-200 PSI | | 2:12mm Tube Fitting | | TF8:½" Tube Fitting | C:Laser Gas Switchover Station |
| | 4:0-200 PSIG | 0-400 PSI | | | | CGA DIN 477 | G:Laser Gas Switchover Station with Alarm (110V) |
| | 5:0-250 PSIG | 0-400 PSI | | | | BS 341 and others available | H:Laser Gas Switchover Station with Alarm (210V) |
| | | | | | | | M:Laser Gas Station |

Related Options

| Option | Order No. | Description |
|-------------------|----------------------------|--|
| Laser Panels | See Page 9 | Three Gas Panel delivery systems for the Laser Gases (Helium, Nitrogen and Carbon Dioxide) |
| Purge Devices | See Page 50 | Tee and Straight Purge configurations to satisfy all requirements |
| Laser Gas Station | Add Letter "M" after inlet | Wall mount bracket, including stainless steel pigtail with check valve in the inlet gland |
| Mounting Bracket | 835-0204 | Rear panel mounting kit |