

213 SERIES REGULATORS



The 213 Series regulators deliver non-corrosive, high purity or liquefied gases (up to grade 4.5) for applications requiring constant low pressure control and delivery regardless of supply pressure variations. With delivery pressures as low as 0.1 PSIG (7 mBAR) that can be adjusted in 0.05 to 0.1 PSIG (4 to 7 mBAR) increments in two delivery pressure ranges, the 213 regulator satisfies any high purity application requiring atmospheric pressures below 5 PSIG (350 mBAR).

Typical Applications

- Gas System Charging
- Fuel Gas Supply Control
- Gas Supply Purging
- Low Pressure Inert Blanketing of Chemicals and Fuel Tanks

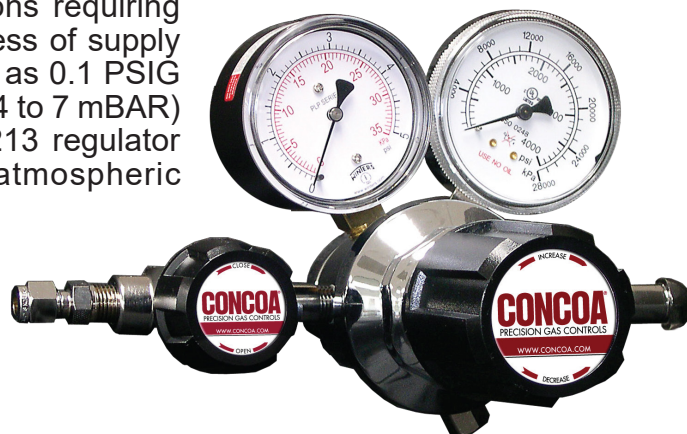

213 1331-580 shown

Features

Standard Relief Valve protects diaphragm and gauges

316L Stainless Steel Diaphragm prevents inboard diffusion

CAPSULE® Seat Technology increases product serviceability and life

Fine Adjusting Screw Thread allows precise pressure adjustment

Materials and Specifications

Maximum Inlet Pressure (bare body): 3000 PSIG (210 BAR); 4500 PSIG (240 BAR) optional

Body: Chrome-plated forged brass

Bonnet: Chrome-plated, die cast zinc

Gauges: 2 1/2 in (63 mm) diameter steel with brass connection (outlet); 2 1/2 in (63 mm) diameter plated case (inlet)

Seats: PCTFE (first stage); PTFE (second stage)

Filter: 10-micron sintered bronze

Temperature Range: -40°F to 140°F (-40°C to 60°C)

Diaphragm: 316L Stainless steel

Cv: 0.02

Helium Leak Integrity: 1×10^{-8} scc/sec

Internal Seals: PTFE

Ports (bare body): 1/4 in FNPT

Conformances: Cleanliness meets or exceeds CGA G-4.1; PED 2014/68/EU; ANSI/ASME B40.1; CRN OH5216

213 SERIES REGULATORS



Installation Dimensions

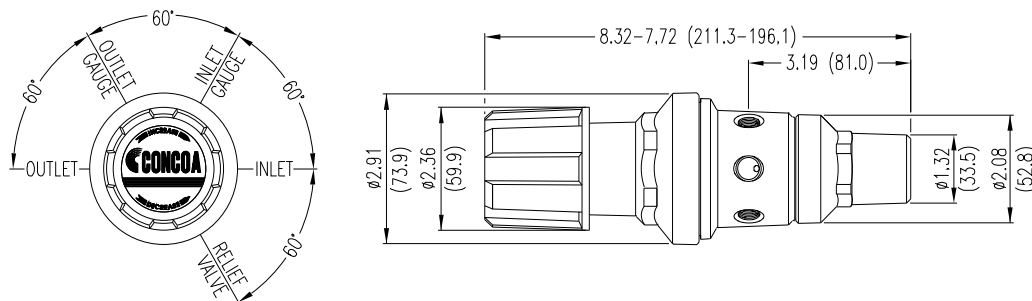

Ordering Information

213	A	B	C	D	-CON	Options	
Series 213	Outlet Pressure	Outlet Gauge	Inlet Gauge	Outlet Assemblies	Assembly Gauges	Inlet Connections	Installed Options
	1: 0-2 PSIG (0-140 mBAR)	0-5 PSIG/ (0-350 mBAR)	0: None	0: 1/4" FNPT port	0: Bare body	000: 1/4" FNPT	B: Protocol alarm station with pressure switch gauges
	2: 0-5 PSIG (0-350 mBAR)	0-10 PSIG/ (0-700 mBAR)	3: 0-4000 PSIG/ 0-275 BAR	1: 1/4" MNPT	1: Standard assembly (PSIG/kPa gauges)	TF2: 1/8" tube	C: Protocol switchover station
			5: 0-1000 PSIG/ 0-70 BAR	2: 1/4" tube fitting	2: Standard assembly (BAR/PSIG gauges)	TF4: 1/4" tube	E: Protocol alarm station with intrinsically safe transducer for hazardous environments
			6: 0-400 PSIG/ 0-27 BAR	3: Diaphragm valve 1/4" tube fitting		TF6: 3/8" tube	H: Protocol switchover alarm station with pressure switch gauges
			8: 0-6000 PSIG/ 0-415 BAR*	4: Diaphragm valve 1/4" MNPT		M06: 6mm tube	J: Protocol alarm station with standard transducer for non-hazardous environments
			9: 0-600 PSIG/ 0-42 BAR	5: Needle valve 1/4" MNPT		CGA DIN 477 BS 341 and others available.	K: Protocol switchover alarm station with standard transducer for non-hazardous environments
		*Max inlet 4500 PSIG (310 BAR) with PCTFE seat CAPSULE®.	6: 1/8" tube fitting				M: Protocol station
			7: 3/8" tube fitting				Q: Protocol purge station
			8: Diaphragm valve 1/8" tube fitting				T: Tee purge
			9: Diaphragm valve 1/4" FNPT				X: Protocol switchover alarm station with intrinsically safe transducer for hazardous environments
			A: 3/8" BSP RH fitting				
			B: Diaphragm valve 3/8" tube fitting				
			C: 3/8" BSP LH fitting				
		D: 6mm chrome hose barb					
		G: 1/8" stainless steel tube fitting					
		H: 1/4" stainless steel tube fitting					
	J: 9/16"-18 "B" RH fitting, bare brass						
	K: 9/16"-18 "B" LH fitting, bare brass						
	L: 5/8"-18 "Inert" RH fitting, bare brass						
	M: 6mm tube fitting						
	S: Diaphragm valve 6mm tube fitting						

213 SERIES REGULATORS



Flow Curves for 213 Series

