

580 SERIES CARBON DIOXIDE MONITOR



The 580 Series Carbon Dioxide Monitor provides continuous monitoring in areas where carbon dioxide is used, stored, may accumulate, or is present during production processes. Once installed, the monitor requires no adjustments or monthly maintenance. The patented non-dispersive infrared (NDIR) CO₂ cell responds to high carbon dioxide conditions within seconds to provide accurate and stable measurements, even in areas where temperature and humidity levels are changing. The CONCOA 580 Series Carbon Dioxide Monitor may be used as a stand-alone gas detector, linked to optional CONCOA single or multi-point controllers, or connected to an existing centralized monitoring system.



580 3008 shown

Typical Applications

- Laboratories with Incubators
- Control Rate Freezers
- Environmental Chambers
- Bioreactors
- Atmospheric Fertilization
- Laboratory or Industrial Gas Storage and Use Areas

Features

- Long Life NDIR Sensor Cell** provides 10+ years of operation under normal conditions with minimum maintenance
- Built-in Non-latching Alarm** resets automatically when alarm condition clears
- Two Adjustable Alarm Setpoints** permit flexible system integration
- Self-calibration Sensor** adjusts to ambient every 180 hours
- Smart Electronics** monitor sensor operation continuously and alerts user to sensor faults
- Optional Remote Digital Alarm Indicator** mirrors the monitor's display providing remote system status in multiple locations

Materials and Specifications

- Sampling Method:** Diffusion
- Gas Detected:** Carbon Dioxide
- Range:** 0-50,000 ppm
- Accuracy:** ±3% of measured value
- Operating Temperature:** 32°F to 122°F (0°C to 50°C)
- Display:** 3/4 in LCD digital display, back lit
- Sensor Type:** Non-dispersive infrared (NDIR) CO₂ cell
- Response Time:** Within one second of any change in CO₂
- Power Requirement:** 24 VDC (350mA)
- Relay Outputs:** Two user-settable alarm relays and one fault relay rated 2A @ ≤ 24 VAC or 24 VDC
- Alarm:** Built-in 90 dB horn and LED indicators
- Enclosure:** Polycarbonate resin (flame retardant and UV stabilized)
- Weight:** 1.6 lbs. (0.8 kg)
- Conformances:** CE approved

580 SERIES CARBON DIOXIDE MONITOR



Installation Dimensions

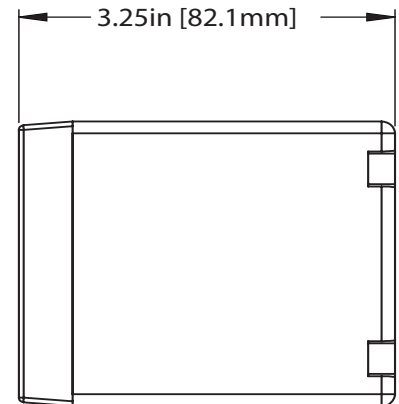
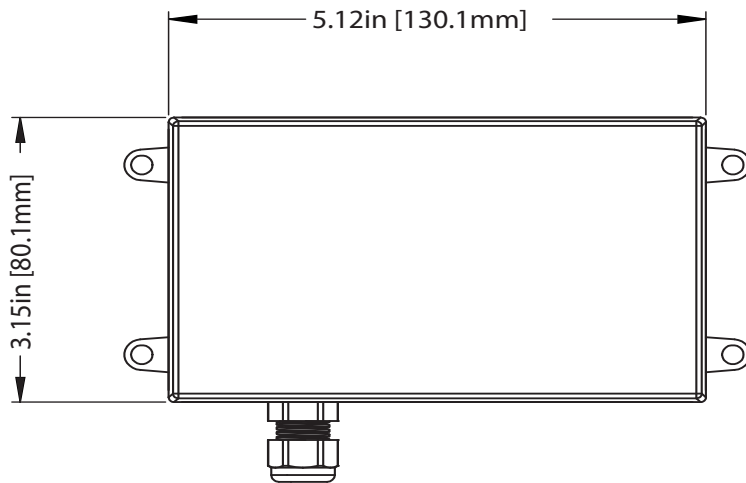

Ordering Information

Part No.	Description	Housing	Weight
580 3008	Carbon Dioxide Monitor with 110 VAC / 24 VDC Power Supply	Polycarbonate	1.6 lbs (0.8 kg)

Related Options

Part No.	Description	Housing	Weight
580 3009	Remote Display Alarm Indicator for Carbon Dioxide Monitor 5803008	PC/ASA Plastic	0.5 lbs (0.23 kg)
580 3006	Horn and Strobe, Red, 82-100 dB @ 10 ft (92-110 dB @ 1 m)	ABS Plastic	0.8 lbs (0.45 kg)
580 3006-A	Horn and Strobe, Amber, 82-100 dB @ 10 ft (92-110 dB @ 1 m)	ABS Plastic	0.8 lbs (0.45 kg)
580 3006-B	Horn and Strobe, Blue, 82-100 dB @ 10 ft (92-110 dB @ 1 m)	ABS Plastic	0.8 lbs (0.45 kg)