

580 SERIES REMOTE DISPLAY



The 580 Series Remote Digital Display is designed for use with CONCOA's 580 Series Oxygen Deficiency Monitor or other CONCOA gas detection system. It is ideal for laboratory, industrial, and confined space environments that use oxygen-depleting or toxic/combustible gases. The remote display mirrors the gas monitor's LED screen, providing clear, highly visible status updates from up to 250 feet from the monitored area. Two user-selectable alarm set points activate high-intensity visual and audible alarms to warn occupants inside and outside the room within seconds of hazardous oxygen or toxic gas levels. An additional fault indicator alerts users to system errors for added safety assurance. The remote digital display connects easily to a CONCOA oxygen deficiency monitor or gas detector via 3-wire, 18-gauge shielded cable. For centralized monitoring and alarm coordination in multiple locations it can also be connected with a facility's programmable logic controller (PLC). The CONCOA Remote Digital Display enhances safety compliance by extending visibility and notification of hazardous breathing conditions beyond the point of detection.



580 3005 shown

Typical Applications

- Laboratories with Incubators
- Control Rate Freezers
- Environmental Chambers
- Bioreactors
- Atmospheric Fertilization
- Biotechnology and Pharmaceutical Laboratories

Features

LED Display provides continuous illumination of oxygen, carbon dioxide, or toxic/LEL gas monitor readings

Built-in Non-latching Alarm resets automatically when gas levels return to safe conditions

Two User-selectable Alarm Setpoints allow customized warning thresholds to match specific safety protocols

85dB Audible Alarm and Fault Status delivers a loud audible alert in noisy environments

PLC Compatible for Facility-wide Alarm Visibility enables integration for centralized alarm indication across multiple monitoring locations

Materials and Specifications

Cable Length: 250 feet

Operating Temperature: -40°F to 122°F (-40°C to 50°C) oxygen; 32°F to 122°F (0°C to 50°C) carbon dioxide

Relay Outputs: Two user-settable alarm relays and one fault relay rated 2A @ ≤ 24 VAC

Power Requirement: 24 VDC (250mA) supply connected from O2 monitors 60 mA

Display: 1" LCD digital display

Alarm: Built-in 80 – 85dB horn and LED indicators

Enclosure: Polycarbonate resin (flame retardant and UV stabilized)

580 SERIES REMOTE DISPLAY



Installation Dimensions

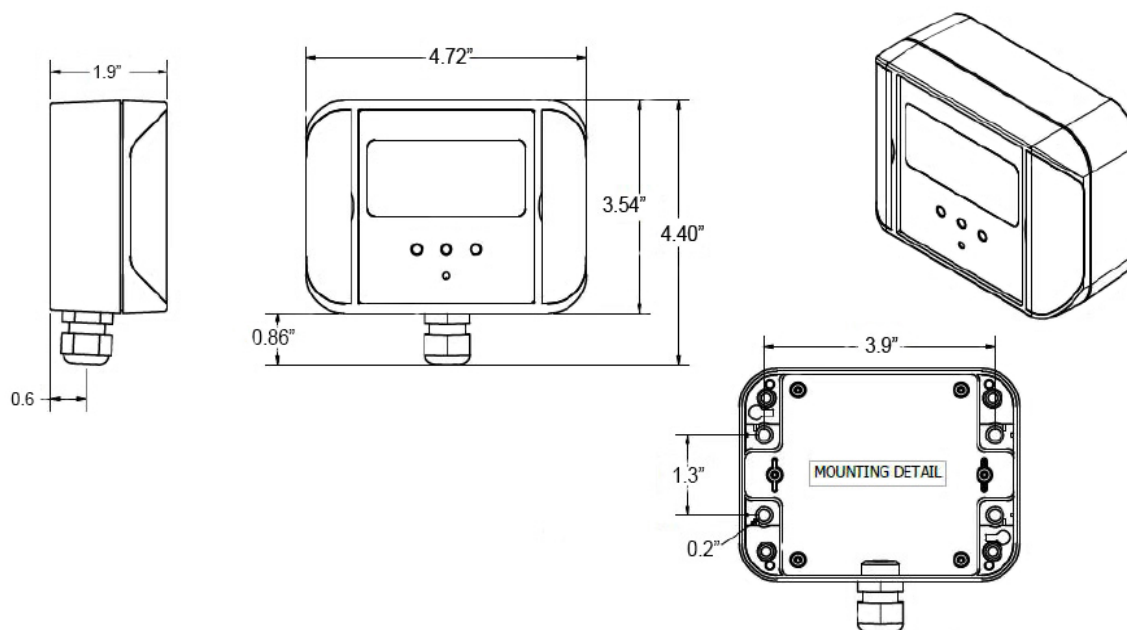

Ordering Information

Part No.	Description
580 3005	Remote Display Alarm Indicator for CONCOA Oxygen Deficiency Monitor 5803004 and Dual O ₂ /CO ₂ Monitor 5803007 (displays O ₂ concentration only)
580 3009	Remote Display Alarm Indicator for CO ₂ Monitor 5803008
580 3045-01-1	Remote Display Alarm Indicator for Toxic/LEL Gas Monitor 580 3044-01-1 (CO PPM detector/transmitter only)

Related Options

Part No.	Description
580 3006	Horn and Strobe; red light; 82-100 dB @ 10 ft (92-110 dB @ 1 m)
580 3006-A	Horn and Strobe; amber light; 82-100 dB @ 10 ft (92-110 dB @ 1 m)
580 3006-B	Horn and Strobe; blue light; 82-100 dB @ 10 ft (92-110 dB @ 1 m)
580 3058-01-1	8-channel Controller for 580 Series Gas Detectors and Oxygen Monitors
580 3063	Alarm Stack Tower, Flat-Mounted, features audible alarm with flashing red light and steady green light
835 2091-6	Optional Wall Mount Base for 580 3063 Alarm Stack Tower
580 3099-01-1	Calibration Gas Cap for 580 3030 Universal Toxic and Corrosive Gas Monitor